

↑pCentric®

Mobile Workstation Poste de travail mobile



Attention: Do not tighten the screws until all of them are in the correct position.

Attention : Ne pas serrer les vis jusqu'à ce qu'elles soient toutes dans la bonne position.

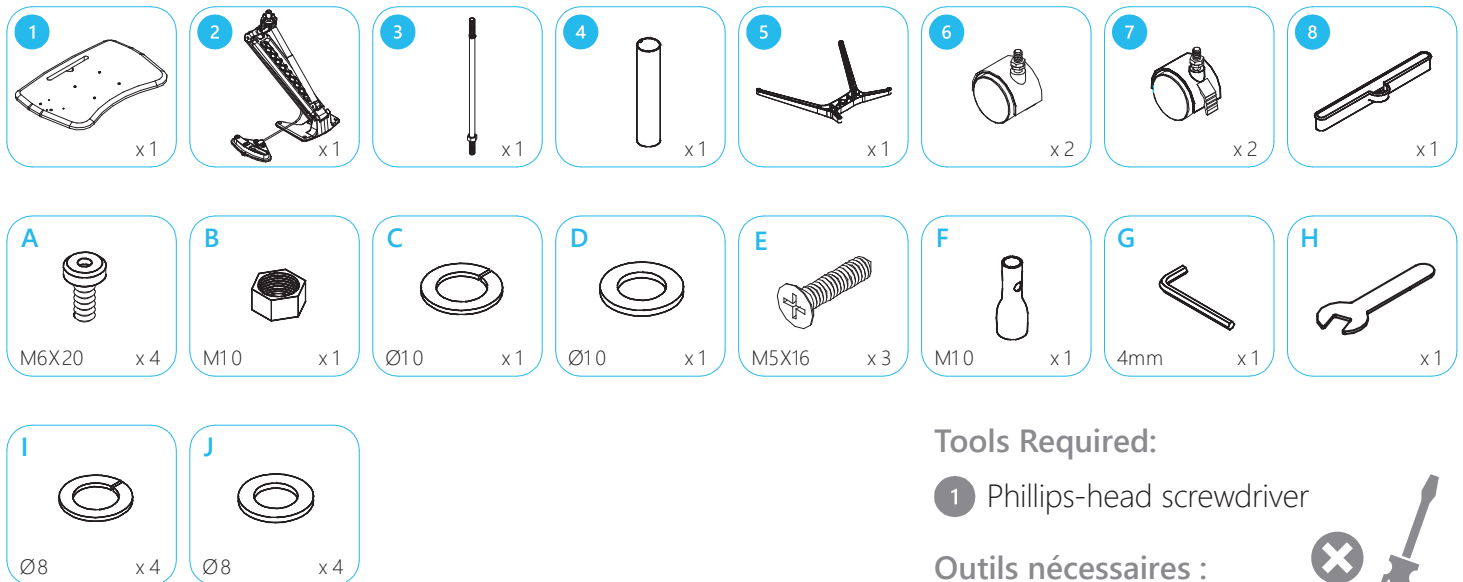

Tools Required:

- 1 Phillips-head screwdriver

Outils nécessaires :

- 1 Tournevis à tête Phillips

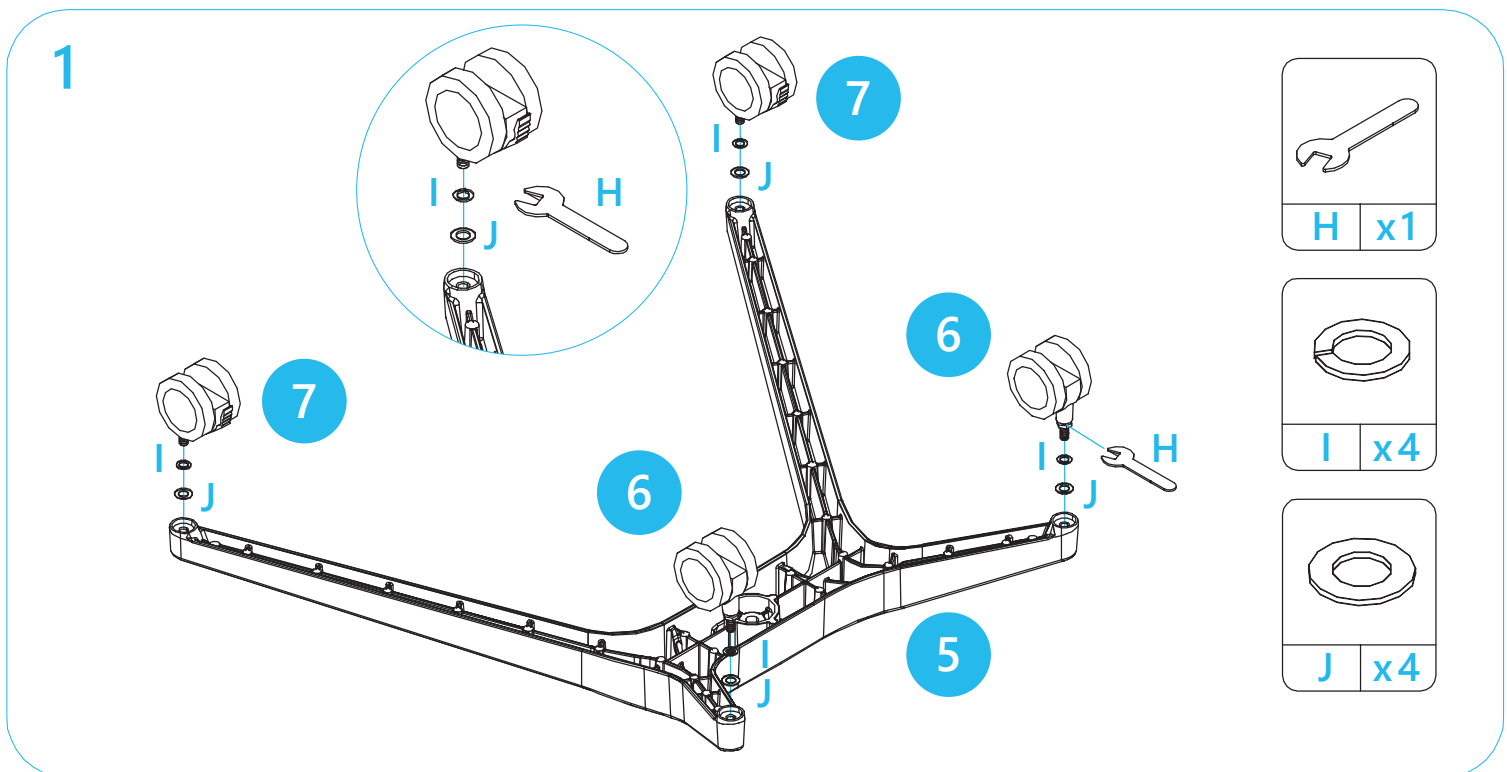

2

NOTE:

Please remove this screw and discard.

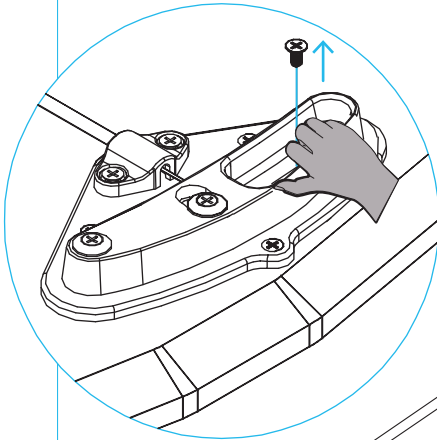

NOTE :

SVP retirer et disposer de cette vis.

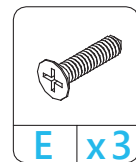
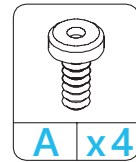
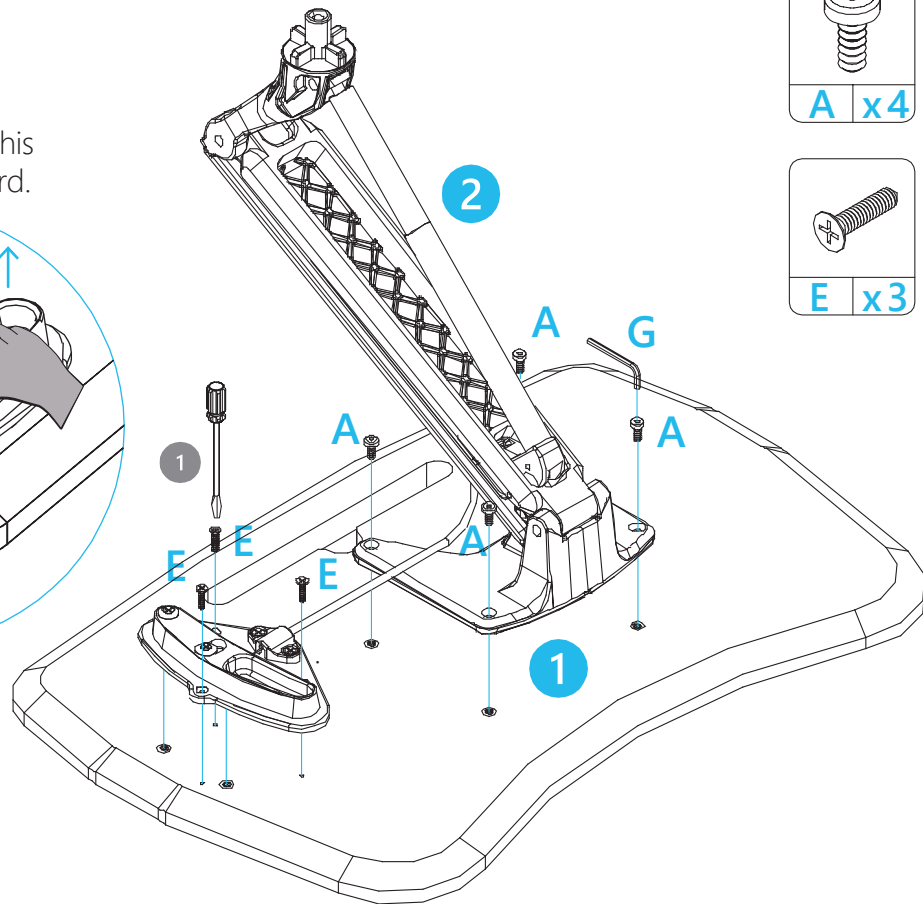

3

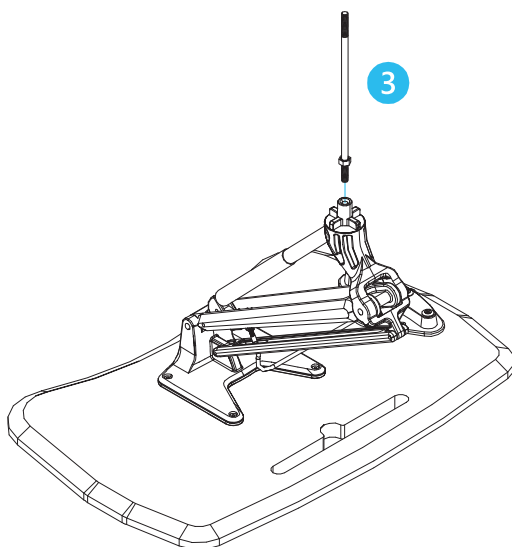

4

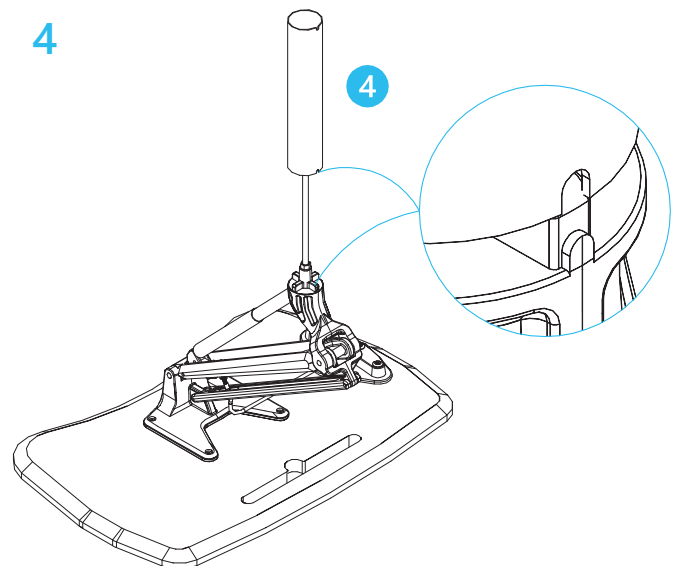

5

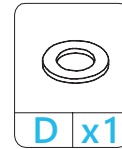
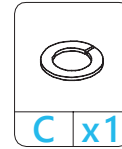
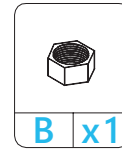
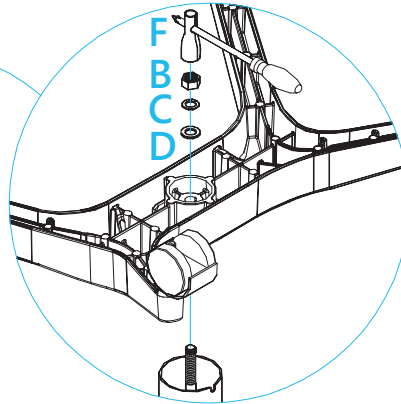
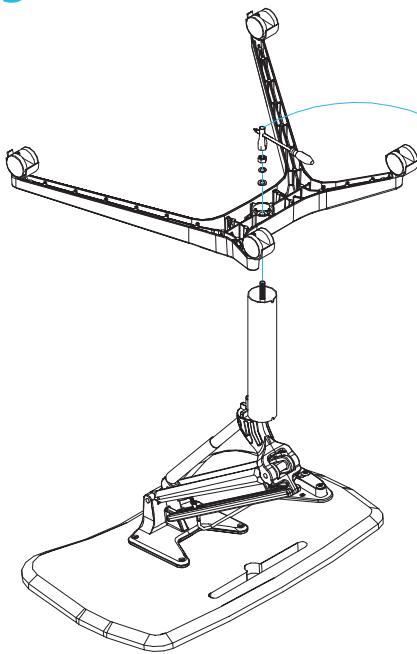

If experiencing difficulty installing part B, revert to step 3 and adjust the nut to provide more thread for installing part B.

Si vous avez des difficultés à installer partie B, revenir à l'étape 3 et ajuster l'écrou pour fournir plus de filetage pour l'installation de la partie B.

6

8

