

Height Adjustable Meeting & Conference Tables



Making Group Work Healthy and Productive

The upCentric Electric Height Adjustable Meeting and Conference Tables allow attendees to easily alternate between seated and standing positions, thus reducing stress and muscle tension, while boosting energy and increasing team productivity.

Gyro Sensor - Anti-Collision Solution

All upCentric height adjustable tables include a patented Gyro sensor anti-collision system for enhanced safety and reduced injuries and damage to property.

Pre-settable Memory Positions - One-Touch Adjustment

Moving the table is intuitive with the easy-to-use up/down control and four settable memory positions. Simply press the button with preset position and the table will automatically adjust to your desired position.

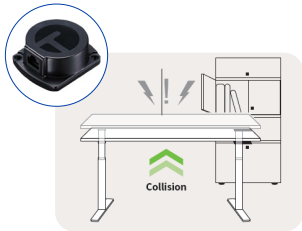

Gyro-Sensor



Pre-settable Memory Positions

Specifications

- Size range: 42"d x 72"w - 48"d x 96"w
- Height range: 22.6" - 49"
- Weight capacity: 175 - 220 lbs
- Tabletop shapes: Rectangular and Race Track
- 1" HPL tabletop surface, available in 16 laminate and edge colours
- Frame is available in Silver and Black
- X-Feet standard, 29" T-leg offered as no charge option
- Edge corners: standard 90°; optional 1" radius corners available
- Standard placement grommet holes or box grommets
- Various Power and Wire Management Accessories available

Warranty*

- 12 year limited warranty
- 7 year warranty: motors, wires and all electronic components

* Includes parts & labour.

High Pressure Laminate (HPL) Finish



21

Kensington Maple



22

Natural Pear



23

Wild Cherry



24

Figured Mahogany

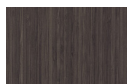

26

Asian Night



27

Black

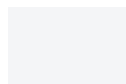

28

Designer White



29

Dove Grey



30

North Sea



33

Vapor Strandz

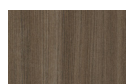

34

Studio Teak



35

Walnut Heights



upCentric Height Adjustable Conference Tables - Oval