

Assembly instructions

upCentric®

Monitor sliders

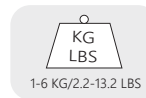
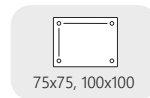
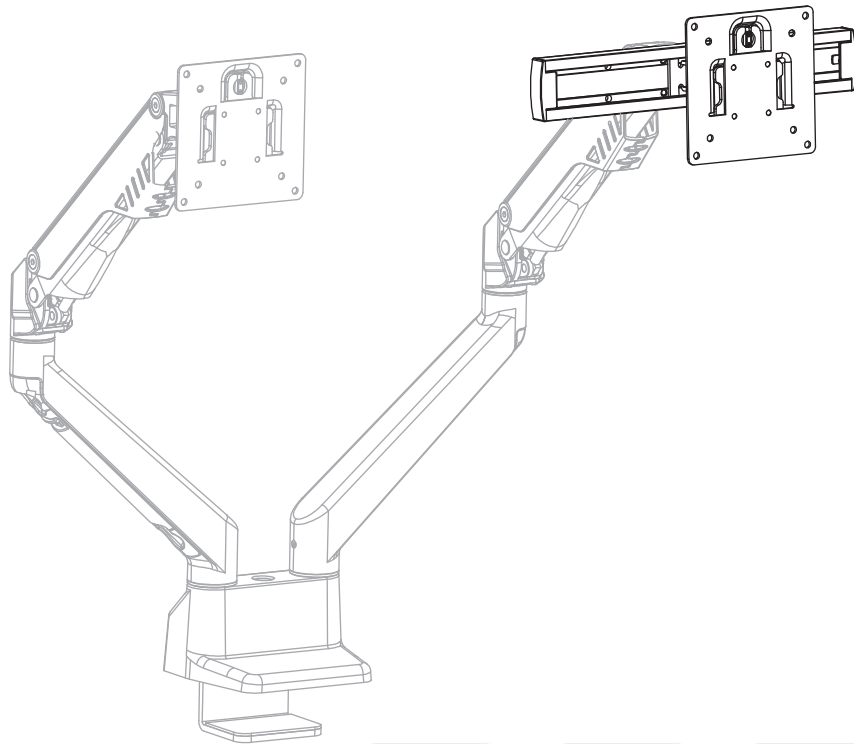

ergoCentric®

1 Parts

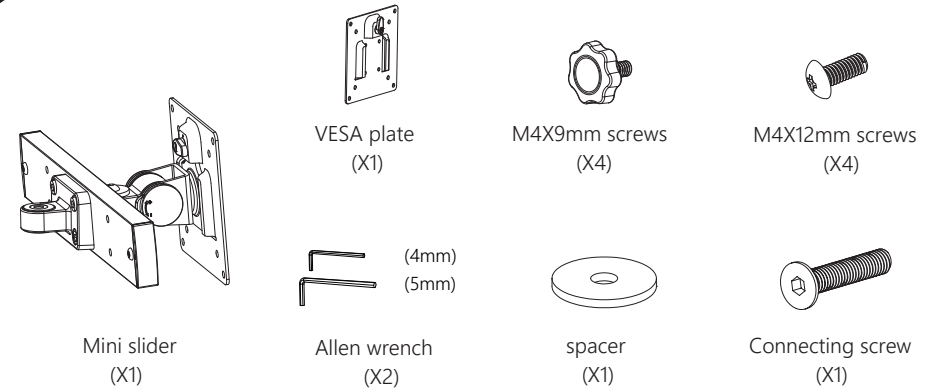

2 Remove the original VESA mount

Loosen the connecting screw.

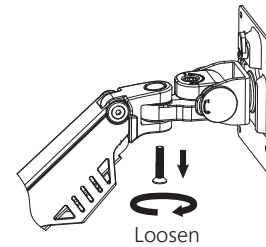

Take down the original VESA mount component.

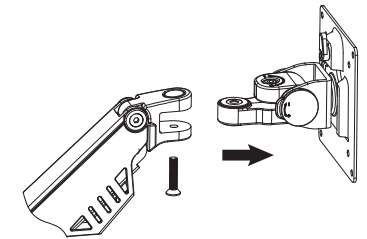

3 Install the mini slide

Insert the mini slide.

Place the metal spacer

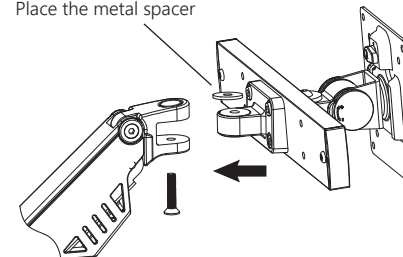

Tighten the connecting screw.

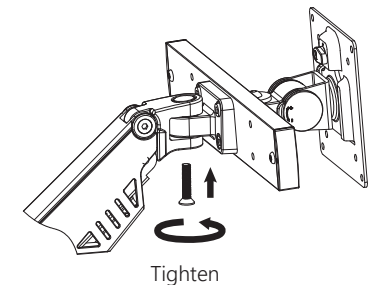

4 Connect VESA plate with monitor

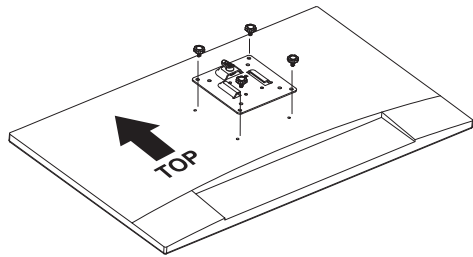

M4X9 screw is the default VESA screw size for most monitors and is designed to be hand-tightened.

M4X12 screw is provided to accommodate monitors requiring longer VESA screws.

5 Monitor installation

Slide in and lock-in.



Before slide in, please make sure the knob on the VESA plate is vertical.



Then turn the knob to right to lock and fix the VESA plate.

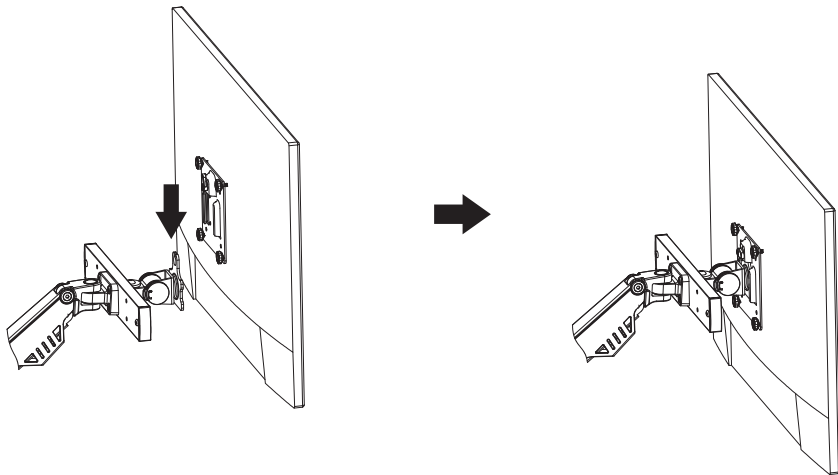

6 Adjustment on the mini slide

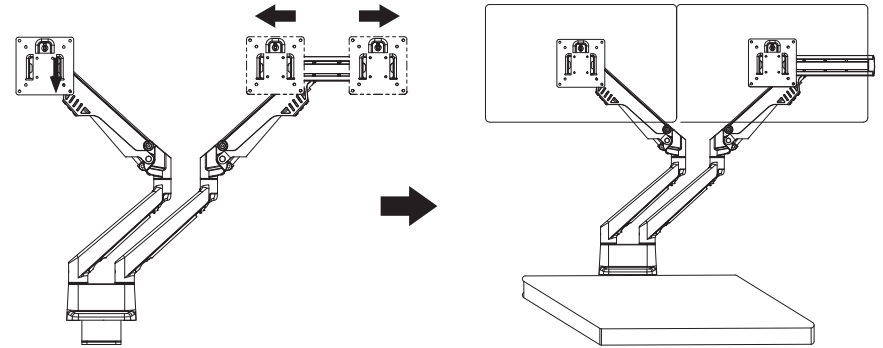

7 3 positions for connection

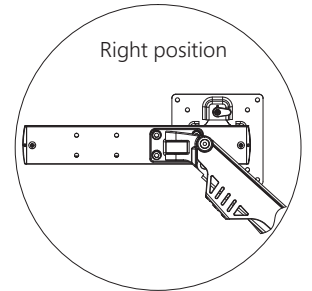
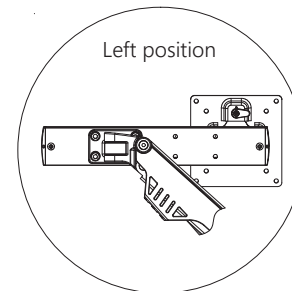
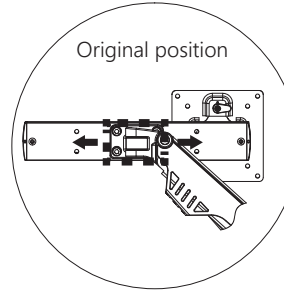

upCentric
Monitor sliders

ergoCentric